

IP20 LED COB Strip Series SPI Strip Series

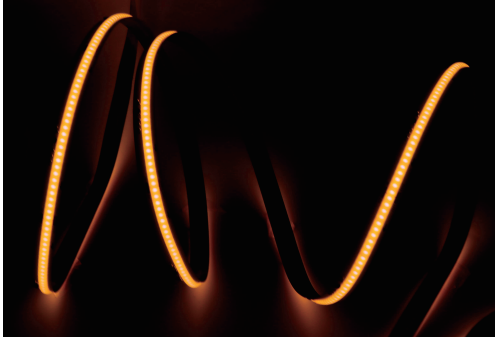

- 360 Flip-Chip LEDs in Linear Array, Integrated Packaging, Uniform Chromaticity, No Spotting
- DC24V Constant Voltage Design, Safety Low Voltage. Standard Cascading 5m
- Monochromatic SPI Dynamic Control with Multi-Pattern Chasing Effects
- High CRI $\geq 90RA$, Back-Mounted High-Tack 3M Tape, Easy Installation, Secure & Durable Bonding
- High-Thermal-Conductivity FPCB Design, Free Bending, Easy Installation
- LED Chips Directly Mounted on FPCB, 170° Beam Angle
- LED Light Source, Energy Saving, RoHS Compliant

Technologies

- SPI

General Application

- This product is suitable for home decoration: engineering projects, large buildings, hotels, shopping malls, indirect lighting, recessed lighting, decorative lighting and other applications.

Color Options

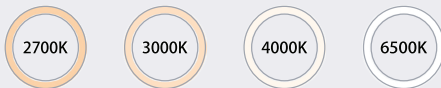

Dimension

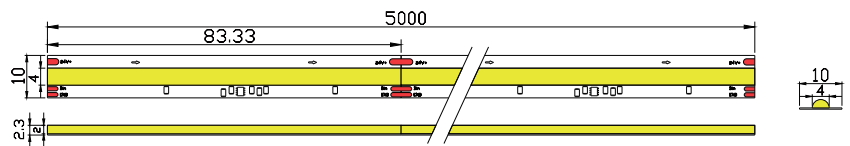

Beam Angle

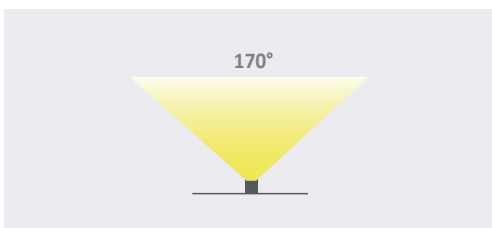

Product Specifications

P/N	LED Quantity	CCT k	CRI	LED (SM)	LUMENS (lm/m)	VIN (v)	Current (mA/M)	Power (W/M)	Cut Length (MM)	Max Run (M)
RL-FV2410360COB11-927-SPI-12	COB	2700	90	360	440	24	450	11	83.33	5
RL-FV2410360COB11-930-SPI-12		3000			440					
RL-FV2410360COB11-940-SPI-12		4000			440					
RL-FV2410360COB11-965-SPI-12		6500			440					

Other Specifications

Protection grade	IP20
Working temperature(°c)	-25~+60
Storage environment temperature (°c)	-25~+70
Standard length	5
Maximum cascade length(m)	5
weight	/

Remark

- The test environment temperature is 25±2°C;
- The above data are typical values, the actual parameters of the product may be different from the typical data; the data is subject to change without notice;
- The above "/" means that this parameter is not required for the time being.

Applied Standards



Installation

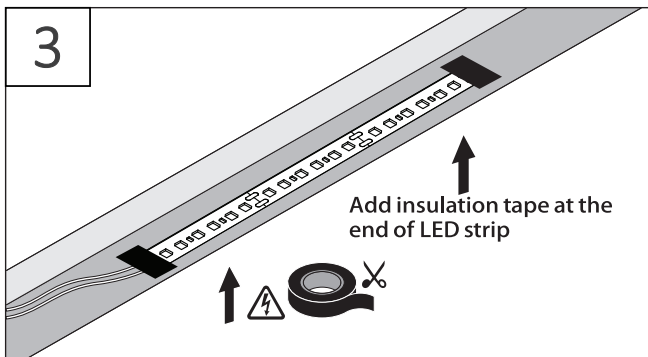
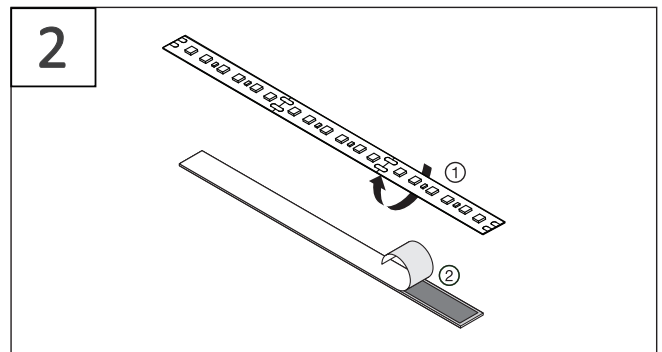
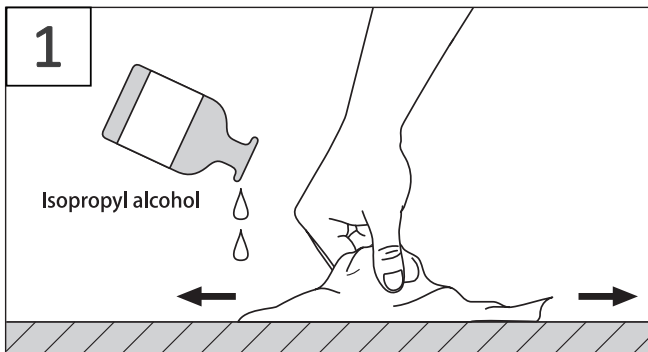

Do's and Don'ts

Minimum Bending Radius

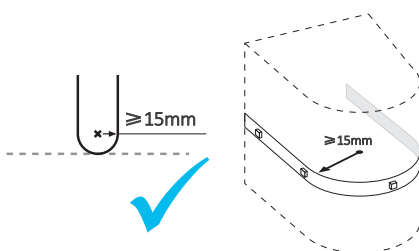

Do Not Twist

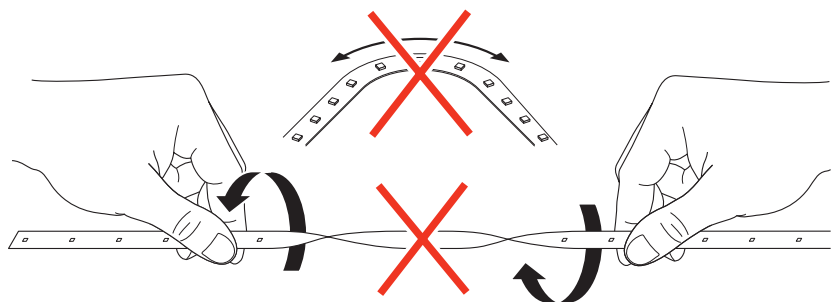

Note: During bending operations, please follow the standard operations in the above diagram. Excessively small bending angles or non-standard operations will cause adverse effects to the product's internals.

Schematic diagram of electrical connection

Monochrome temperature wiring diagram 1: Power + lamp belt connection mode

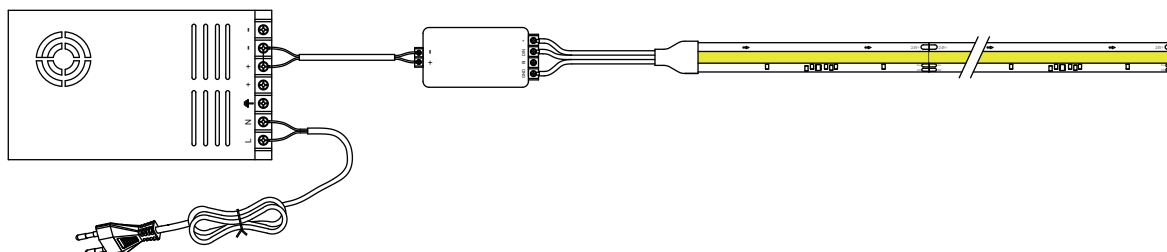

Package

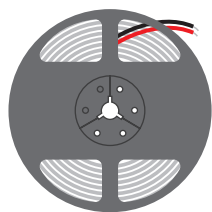

Reel



Electrostatic bag

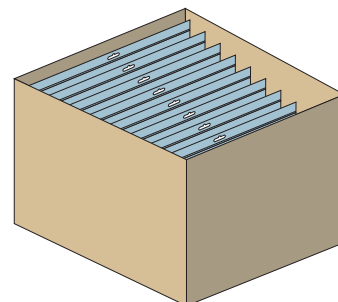

Carton

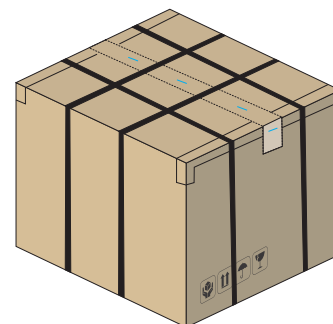

Packing completed

Quantity per roll (m)	Quantity per case (m)	Total weight (Kg)	Outer box dimensions (mm)		
			Length	Width	Height
5	200	≤ 20	550	550	240

Note :The above-mentioned packaging quantity and weight are only for the packaging method shown in the figure. There will be differences in the number and weight of packaging for other packaging methods, and the actual product shall prevail.

Common product faults and their troubleshooting methods

Fault Phenomena	Possible Causes	Troubleshooting Methods
All lights off	1.Mains power failure	Power on
	2.Open circuit or short circuit at switching power supply output triggering auto-protection	Troubleshoot and restore power
	3.Reverse polarity at LED strip power input	Check wire connection status to ensure correct polarity
Partial lights off	1.Partial switching power supply failure	Inspect power supply system and resolve faults
	2.Wiring error in partial LED strip circuits	
	3.Reverse polarity in partial LED strips	Correct wiring
LED uneven brightness or insufficient brightness	1.Power supply overload	Replace with higher-power supply according to load
	2.Excessive line loss in switching power circuits or significant line loss discrepancies	Maintain LED strip operating voltage within $\pm 5\%$ of rated voltage 1.Shorten power cable length between power supply and LED strip or use larger gauge wires; 2.Ensure number of LED strips per circuit \leq max allowed cascading quantity and keep cascading quantities similar per circuit).
	3.Excessive serial connection of LED strips	Adjust LED strip quantity per power branch to meet max allowed cascading requirements per circuit
LED flickering	1.Poor contact at connection points	Identify and resolve poor contact points
	2.Switching power supply malfunction	Replace switching power supply

Notice

- If the external flexible cable of this product is damaged, the cable must be replaced by the manufacturer or similarly qualified personnel to prevent hazards.
- For specific installation arrangements and precautions, refer to the product user manual.
- Data in this specification is based on standard products. Actual delivered products may vary, subject to physical measurements.
- All product diagrams in this specification are schematic diagrams. Actual delivered products may differ, subject to physical objects.
- Technical modifications may be implemented without prior notice.
- Shenzhen Meishang Lighting Co., Ltd. reserves the final interpretation rights of this manual.



Specialized
LED Strip Manufacturer

Shenzhen
Relight Technology Co.,Ltd

6th Floor, Building A, Guancheng IndustrialPark,Gongming Town,
Guangming District, Shenzhen, China

Tel: 86 0755 3369 1713
Web: www.relight-tech.com
E-mail: Sales@relight-tech.com