

1020 Double-sided Emitting Neon Strip Data Sheet



- 10x20mm neon double-sided emitting design
- Uniform light effect, no color deviation, so and smooth light
- Single-end power supply supports 5M connections
- Integrated silicone extrusion molding process using food-grade silicone material
- Anti-yellowing, high-temperature, corrosion resistance, simple installation
- Waterproof grade IP67
- 5 years warranty

Technologies

- ON/OFF, SPI

Application

- This product is suitable for outdoor lighting, decorative lighting in buildings, hotels, shopping malls, etc.

Color Options



Dimensions

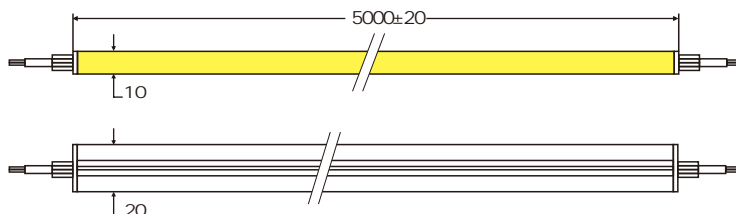

Beam Angle

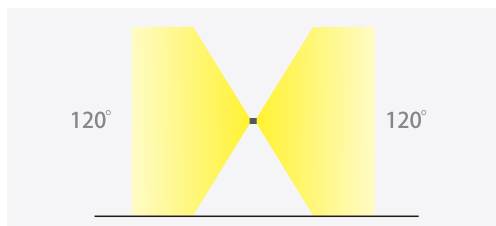

Sectional drawing

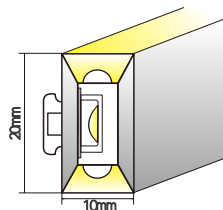

Recommended Accessories

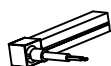

Side exit
end cap

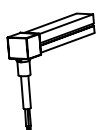

Bottom Exit
end cap



Direct Exit
End cap



End cap



Bendable Profile



Clip

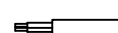

cable

Product Specifications

P/N	LED Quantity	CCT K	CRI	LEDs/m	LUMENS (lm/m)	Vf. (V.)	Current (mA/M)	Power (W/M)	Out Length (MM)	Max Run (M)
RL-FV2410140283510-827-FWS1020	2835	2700	80/90	140	450	24	417	10	50	5
		3000			450					
		4000			470					
		5700			470					
RL-FV2410084505016-SIP-FWS1020 (SM16703P)	5050RGB	R:620-625 G:520-525 B:465-470	80/90	84	240	24	417	10	50	5

Other Specifications

Protection grade	IP67
Working temperature (°C)	-25~+60
Standard length (°C)	-25~+70
Maximum cascade length(m)	5
Maximum cascade length (m)	5
weight	/

Remark

- The test environment temperature is 25±2°C;
- The above data are typical values, the actual parameters of the product may be different from the typical data; the data is subject to change without notice;
- The above "/" means that this parameter is not required for the time being.

Applied Standards



Installation

Note: Due to the different types and attributes of neon lights, please refer to the line marks for the bending radius

① Bending Direction & Min. radius

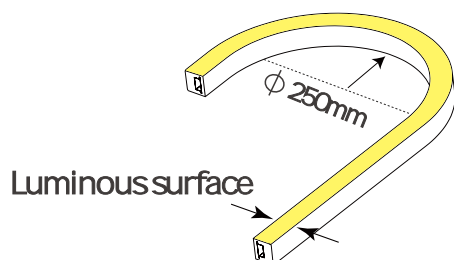

② Top bending prohibited

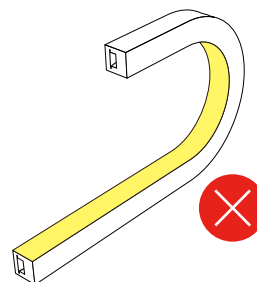

Mounting with aluminium profiles

Install with the screws provided. Do not use screws of other types or sizes that do not meet requirements.



Description	W (mm)	H (mm)	Item Code
11020797	20	7.3	/

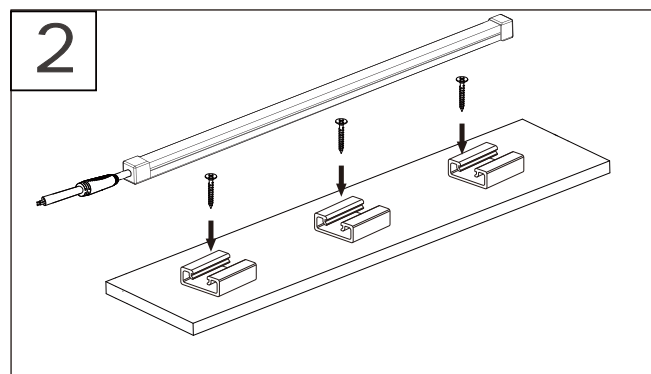
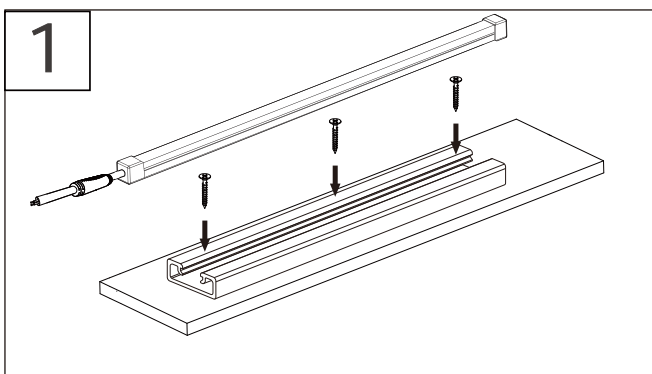
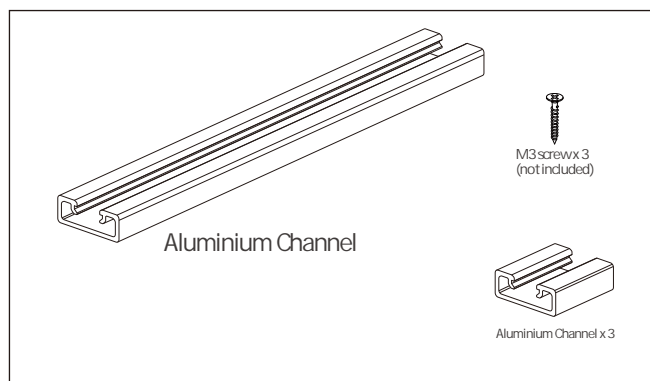

IESreport

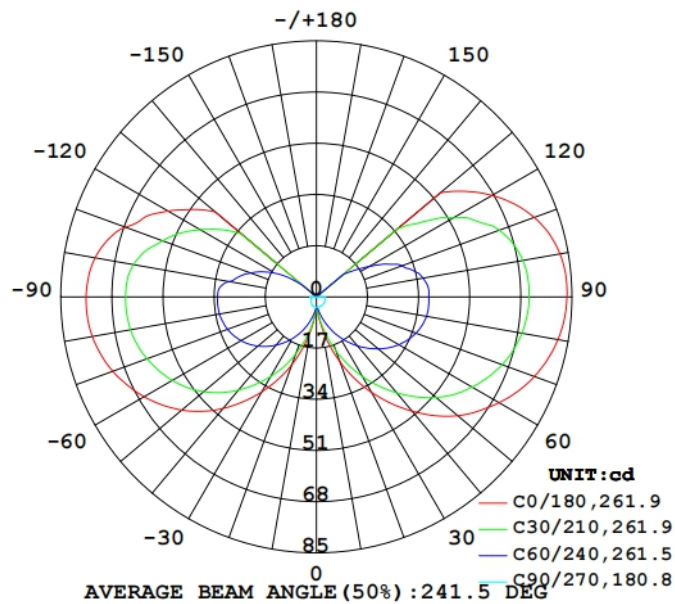

Schematic diagram of electrical connection

1. Monochrome temperature wiring diagram 1: Power + lamp belt connec on mode



2.SPI wiring diagram: Power + controller + light belt connec on mode

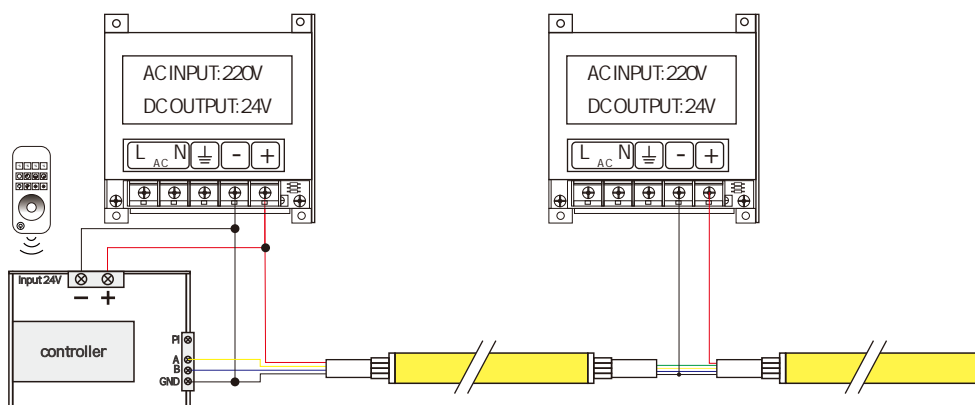

Package

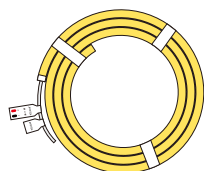

Reel

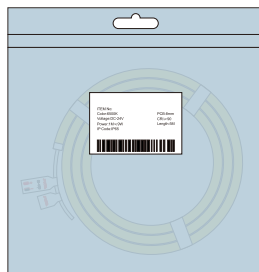

Electrostatic bag

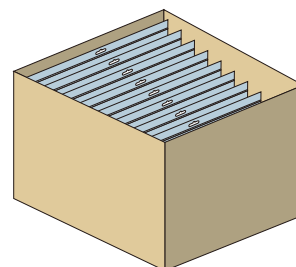

Carton

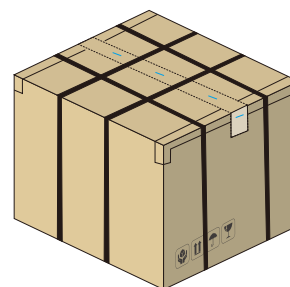

Packing completed

Quantity per roll (m)	Quantity per case (m)	Total weight (Kg)	Outer box dimensions (mm)		
			Length	Width	Height
5	100	20	550	550	240

Note : The above-mentioned packaging quantity and weight are only for the packaging method shown in the figure. There will be differences in the number and weight of packaging for other packaging methods, and the actual product shall prevail.

Common product faults and their troubleshooting methods

Fault Phenomena	Possible Causes	Troubleshooting Methods
All lights o	1. Mains power failure	Power on
	2. Open circuit or short circuit at switching power supply output triggering auto-protection	Troubleshoot and restore power
	3. Reverse polarity at LED strip power input	Check wire connection status to ensure correct polarity
Paral lights o	1. Parallel switching power supply failure	Inspect power supply system and resolve faults
	2. Wiring error in parallel LED strip circuits	
	3. Reverse polarity in parallel LED strips	Correct wiring
LED uneven brightness or insufficient brightness	1. Power supply overload	Replace with higher-power supply according to load
	2. Excessive line loss in switching power circuits or significant line loss discrepancies	Maintain LED strip operating voltage within $\pm 5\%$ of rated voltage 1. Shorten power cable length between power supply and LED strip or use larger gauge wires 2. Ensure number of LED strips per circuit (max allowed cascading quantity and keep cascading quantity similar per circuit).
	3. Excessive serial connection of LED strips	Adjust LED strip quantity per power branch to meet max allowed cascading requirements per circuit
LED flickering	1. Poor contact at connection points	Identify and resolve poor contact points
	2. Switching power supply malfunction	Replace switching power supply



- If the external flexible cable of this product is damaged, the cable must be replaced by the manufacturer or similarly qualified personnel to prevent hazards.
- For specific installation arrangements and precautions, refer to the product user manual.
- Data in this specification is based on standard products. Actual delivered products may vary, subject to physical measurements.
- All product diagrams in this specification are schematic diagrams. Actual delivered products may differ, subject to physical objects.
- Technical modifications may be implemented without prior notice.
- Shenzhen Meishang Lighting Co., Ltd. reserves the final interpretation rights of this manual.



Specialized
LED Strip Manufacturer

Shenzhen
Relight Technology Co.,Ltd

6th Floor, Building A, Guancheng Industrial Park, Gongming Town,
Guangming District, Shenzhen, China

Tel: 86 0755 3369 1713
Web: www.relight-tech.com
E-mail: Sales@relight-tech.com